

## Compressor Mount Kit

Mercedes Vito (W447) 2.1L (-AC) 10.2014>

Model Type : 114 / 116 / 119 BlueTEC with 7G Tronic plus gearbox  
 Engine Type : OM 651 DE22LA Euro 6

KIT NOS	DESCRIPTION	COMPRESSOR
0500.8062	CMK SP - Mercedes Vito (W447) 2.1L (-AC) 10.2014>	SELTEC/QUE TM/QP13, 15, 16

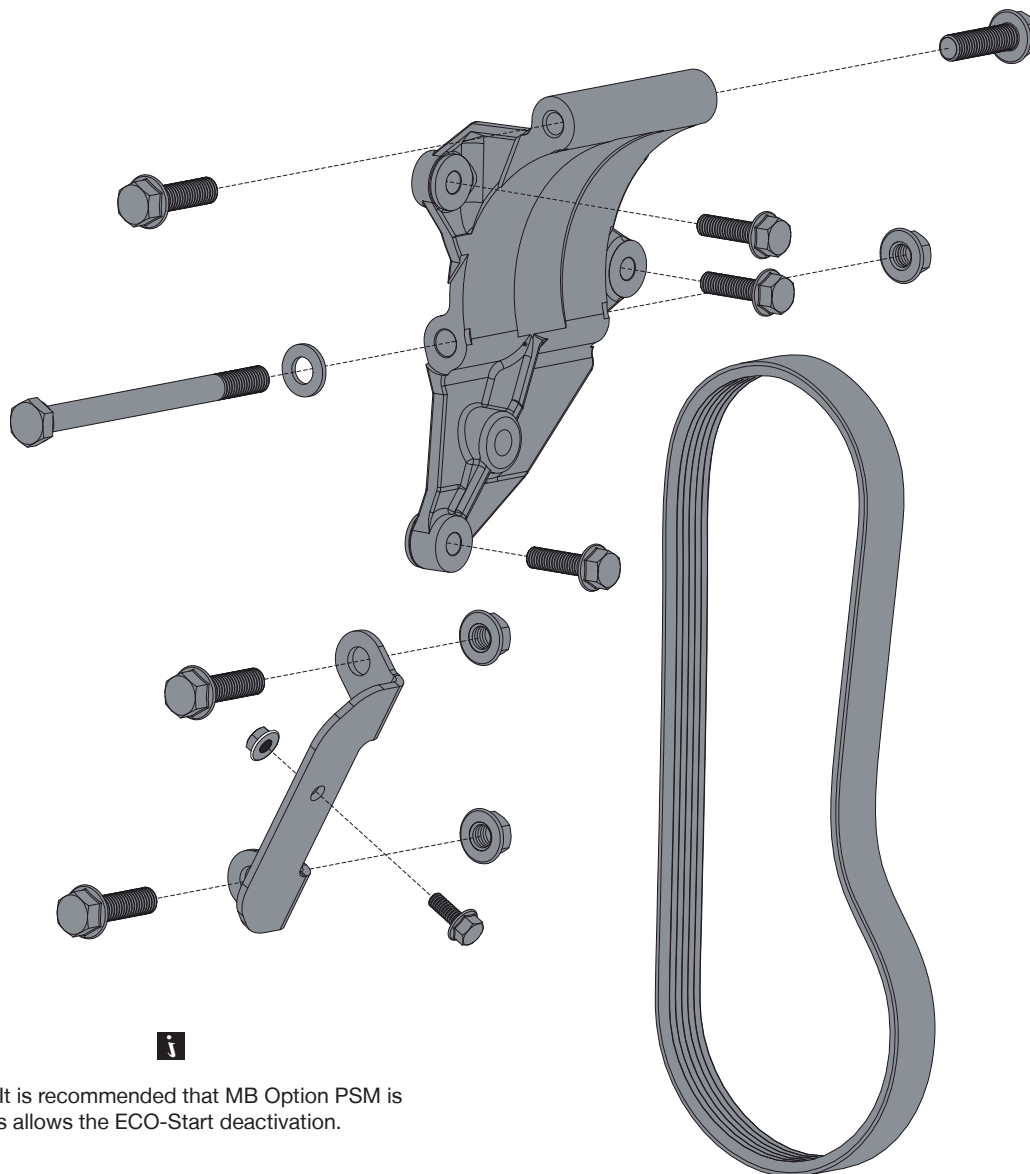

© Techni Ltd.2016

### Note

ECO-Start. It is recommended that MB Option PSM is utilised. This allows the ECO-Start deactivation.

## Recommended Compressors

	TM-13	TM-15	TM-16	QP-13	QP-15	QP-16
Comp No.	0381.0202	0381.0132	0381.1042	0391.0202	0391.0132	0391.1042
OE No.	435-45120	435-55121	435-56121	QP13-1302	QP15-1172	QP16-1196
Mounting	Ear	Ear	Ear	Ear	Ear	Ear
Rotor	8PV	8PV	8PV	8PV	8PV	8PV
GL	46.55mm	46.55mm	46.55mm	46.55mm	46.55mm	46.55mm
Armature	3E	3E	3E	3E	3E	3E
Diameter	123	123	123	123	123	123
Voltage	12	12	12	12	12	12
Orientation	V	V	V	V	V	V
Fitting	3/4 x 7/8	3/4 x 7/8	3/4 x 7/8	3/4 x 7/8	3/4 x 7/8	3/4 x 7/8
Manifold	Bolt	Monolithic	Monolithic	Bolt	Monolithic	Monolithic